

MBL 350

LED Marine Lantern



The MBL 350 is a LED flashing lantern of medium and long range, with a great optical efficiency and low consumption. Its luminous source consists of high-power LED diodes, obtaining a range of up to 20 nautical miles.

Intended to be placed in on-shore aids-to-navigation locations, such as poles and towers, with a minimum maintenance.

Fitted with 6 nos. optical elements by level, arranged in a circular way in a 250mm diameter, made from UV-resistant methacrylate and protected with a shock-resistant acrylic lens cover. Manufactured with high-quality and resistant materials, this lantern provides a long service life under severe marine conditions.

Designed according to IALA Recommendations.

Features:

- High-efficiency luminous system.
Up to 13 nm (T=0.74), 20 nm (T=0.85).
- Vertical divergence up to 12°.
- 360° horizontal output.
- Average operation lifetime over 10 years.
- Photocell adjustable in lux.
- IP 67 watertightness degree (immersion resistant).
- Linear adjustment of luminous intensity.
- Double RS-232 serial port for setting adjustments by PC and remote monitoring system.
- Programming, configuration and operating status via PC, IR programmer or Bluetooth.
- Ready to integrate remote monitoring via GSM, VHF or satellite, synchronization via GPS or AIS AtoN module.
- Short-circuit, reverse-polarity and transient over-voltage protections.
- PATENTED OPTICAL SYSTEM.



MBL350

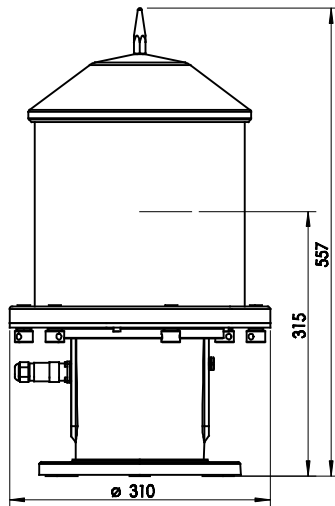

MBL 350 of 3 levels.

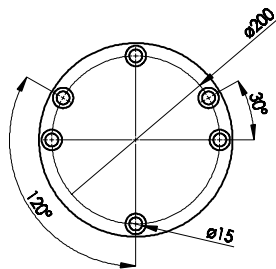

Mediterráneo Señales Marítimas, S.L.

Pol. Ind. Mas de Tous - C/ Oslo 12
46185 La Pobla de Vallbona - Valencia SPAIN

+34 96 276 10 22

✉ msm@mesemar.com🌐 www.mesemar.com

Optical System

Light source:	18 to 36 nos. ultra-bright LED diodes, with high-precision acrylic lens.
Luminous range:	Up to 13 nm (T=0.74) 20 nm (T=0.85).
Colours available:	White, green, red, amber and blue.
Vertical divergence:	From 5° to 12° (50% Io).
LED average life:	More than 100,000 hours.
Power supply:	From 9 to 36V.
Lantern consumption:	From 36 to 72W.

Electronic control

Flash rhythms:	256 (6 nos. user selectable).
Day/night threshold:	Adjustable between 10 and 400 lux.
Settings:	PC / IR programmer / Bluetooth.
Luminous intensity adjustment:	Linear, between 10 and 100%.
Light intensity reduction due to low battery:	Configurable by the user.

Materials and environment

Base:	Glass-fibre reinforced polyamide PA66-GF30.
Lens cover:	Acrylic, UV stabilised.
Shock resistance:	MIL-STD-202G, Method 213B.
Watertightness degree:	IP 67.
Fixings:	3 - 4 bolts in a 200mm diameter.
Humidity resistance:	100%. Pressure-compensation valve to avoid condensation.
Temperature range:	From -30° to 70°C.
Inside hardware:	Stainless steel.

Peak intensities (Cd)

Colour	Vertical divergence 5°		Vertical divergence 12°	
	3 levels	6 levels	3 levels	6 levels
White	3,510	7,020	1,635	3,270
Green	2,235	4,470	1,302	2,604
Red	1,500	3,000	807	1,614
Amber	1,986	3,972	1,104	2,208

Other divergences available.

Options

Infrared (IR) programmer.
PC programming kit.
RS-485 MODBUS serial port.
Marine aluminium base.
Other specifications available under request.
MBL 350-HD (up to 30° divergence).
MBL 350-SYNC (GPS synchronisation).
MBL 350-TG (GSM remote monitoring).
MBL 350-TR (Radio remote monitoring).
MBL 350-TS (Satellite remote monitoring).
MBL 350-AIS (AIS AtoN).