

RBM30

Rotomoulded polyethylene

RBM30 polyethylene buoys are designed for both sheltered and open-sea waters, thanks to the large capacity of its float of 3.0 meters in diameter, in high-quality rotomoulded virgin polyethylene.

UV protection

Polyethylene includes the necessary pigment that provides the colour. UV filters guarantee a stable colour protection during its whole service life. To ensure its buoyancy, the float is filled with closed-cell expanded polystyrene foam.

Long service life

The floats are made up of several sections. Metallic buoy parts (superstructure and tail) made from hot-dip galvanized steel, and designed to provide a long service life under the harshest marine conditions. There are standard models with short tail or high visibility frame, to meet the most specific markup needs. They can be customized under client's request.



Region A



FEATURES

- Float made from high-quality rotomoulded virgin polyethylene, 12 mm thickness. Other thicknesses available on request.
- Float filled with closed-cell expanded polystyrene foam inside.
- Metallic parts from hot-dip galvanized steel
- Impregnated color in polyethylene.
- Chromaticity according to IALA Recommendations.
- Protection against ultraviolet rays.
- Compatible with a large variety of self-contained and marine LED lanterns.
- Top mark to increase the visibility of the buoy during the day.
- Passive radar reflector of 10 m² RCS.
- Stainless steel screws.
- Minimal maintenance.
- Designed according to IALA Recommendations.

RBM30

	(D) Float diameter	(A) Focal Height	(FH) Float Height	(C) Draft	(H) Total height	Float Volume	Total weight	Max. chain
RBM30	3.0 m	6.7 m	1.9 m	5.13 m	13.5 m	8.6 m ³	2,588 kg	3,400 kg
RBM30HV	3.0 m	6.4 m	1.9 m	5.12 m	12.5 m	8.6 m ³	2,522 kg	3,300 kg

* Other volumes and heights available under request.

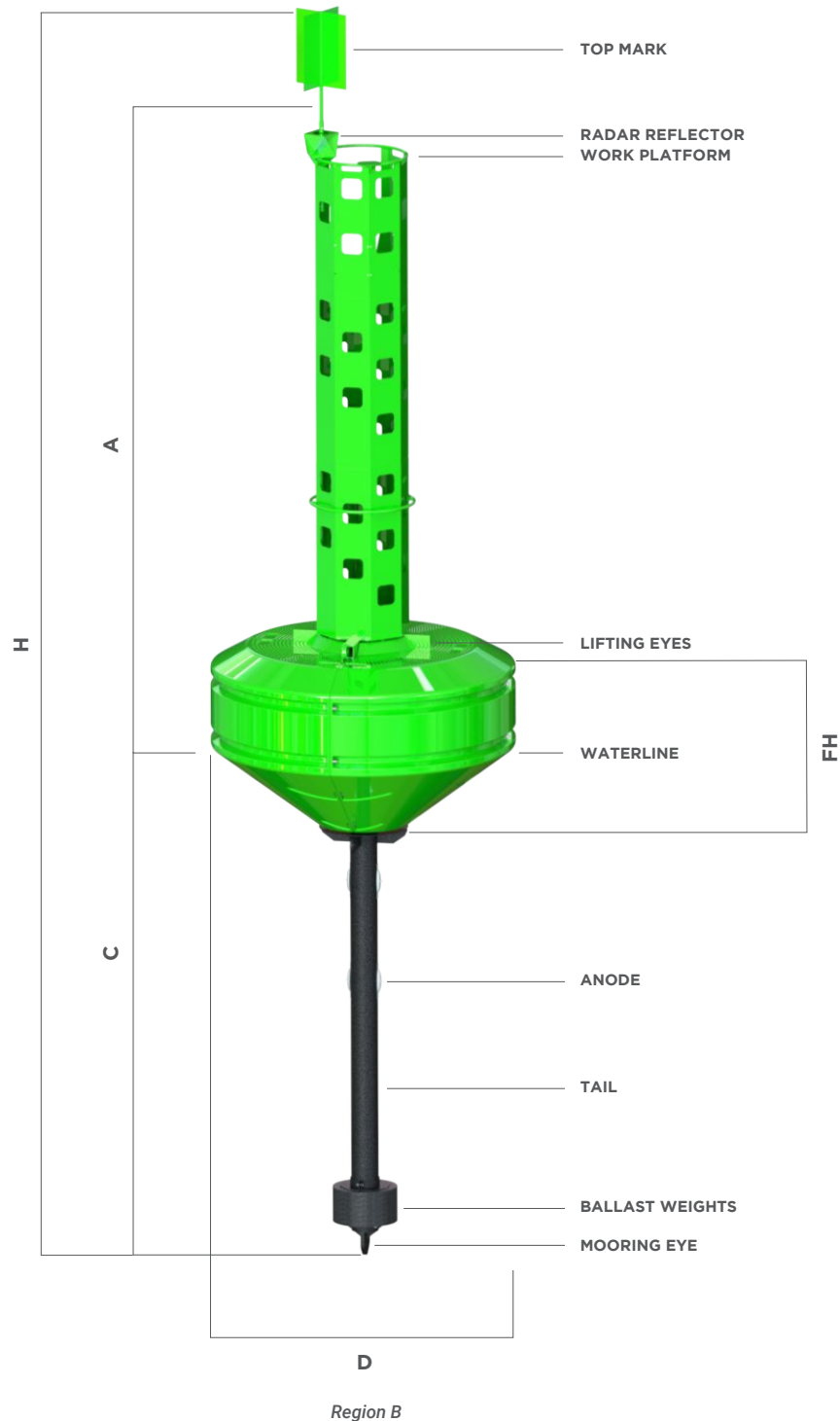

RBM30

■ Versions

RBM30



RBM30HV

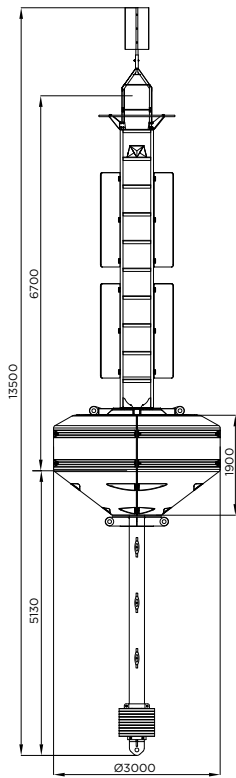

Region A

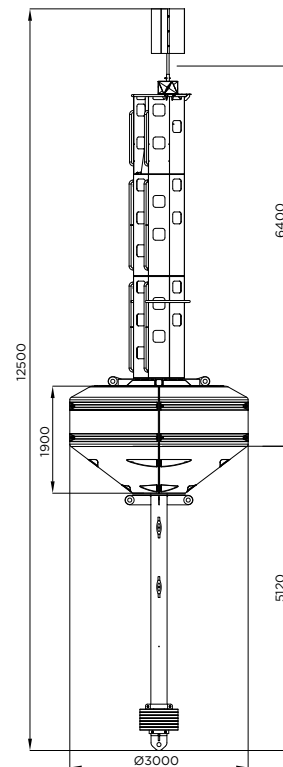

Region B

RBM30

Superstructure

Material:	Hot-dip galvanized steel.
Coating:	UV- and corrosion-resistant polyurethane paint.
Day marks:	GRP.
Top mark:	GRP, according to IALA Recommendation.
Radar Reflector:	10 m ² (X band).
Lifting eyes:	2 nos.
Hardware:	Stainless-steel.

Float

Diameter:	3.0 meters.
Material:	12 mm thickness rotomoulded virgin polyethylene.
Filling:	Closed-cell polystyrene (15 kg/m ³).

Tail

Material:	Hot-dip galvanized steel.
Ballast weights:	Treated steel, detachable.
Mooring eye:	1 no.
Protection:	Sacrifice anodes.

Options

- Superstructure made from stainless-steel or marine aluminium.
- Top mark available in stainless-steel.
- High-visibility day marks.
- Cast-iron ballast weights.
- Closed-cell expanded polyurethane foam filling available under request.
- Short tail available (PBM30).
- Other thicknesses available on request.



Specifications subject to change without previous notice.

